

## Over 25,000 times in Germany and Europe: Haase basement tank – Technical information

### Approval

Haase basement tanks of the double-walled "D" series possess a national technical approval certificate no. Z 40.11-127 from the German Institute for Construction Technology, Berlin (DIBt) for the overground storage of heating oil, diesel fuel, fresh and used gearbox and engine oils, flat-base tanks for special media (e.g. chemicals, waste water) an approval certificate no. Z 40.11-216. These approvals are valid for the whole of the Federal Republic of Germany. Manufacturing and our specialist installation contractors are subject to independent monitoring to DIN 18200.

### No catch trough

Haase basement tanks of the "D" series are designed as double-walled cylindrical tanks and are supplied with an automatic leakage indicator system.

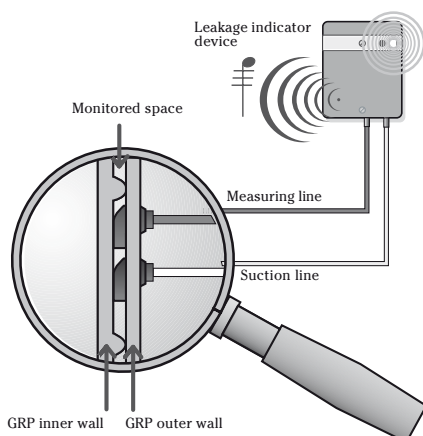

In special cases, it is also possible to supply single-walled tanks without leakage indicator.



### Buoyancy precautions

For flood-risk areas, Haase basement tanks can be provided with a type-approved buoyancy precaution.

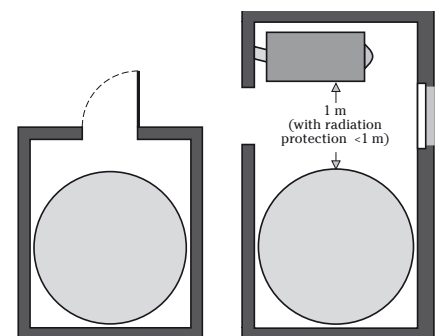

### Small through the door – large in the basement!

Even complicated building layouts are no problem for our basement tanks. The tank is delivered in separate parts: the walls rolled up like carpet, the base and top – if necessary – each in two halves. It is thus certain to fit through any door, and even narrow hatchways. The tank is then assembled at its final place of installation.

### Optimum space utilisation

Normally, a single Haase basement tank is able to hold the whole annual heating oil requirements for a house. Thanks to their safety concept, no

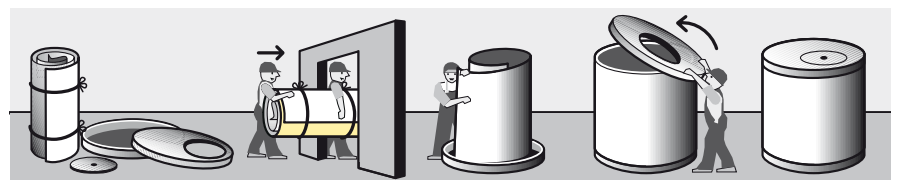

## Haase basement tanks – 10 diameters with variable heights

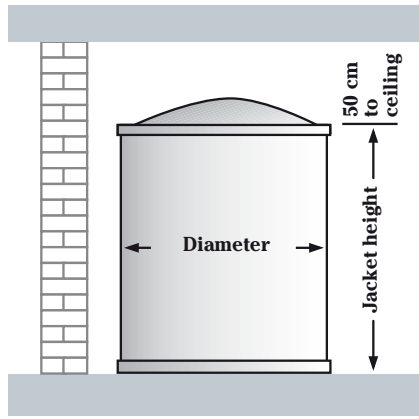

minimum wall clearance is prescribed for double-walled tanks.

Only for the series K 30, K 35 and K 40 – the Haase jumbos – is a clearance of 20 cm to the surrounding walls required, namely for assembly.

The required minimum height of the basement room is calculated as the jacket height + 50 cm.

Haase basement tanks with capacities up to 5,000 litres can be installed in the boiler room itself. If suitable heat radiation protection is provided, they can even stand closer than 1 metre from the burner.

### The technology

The high-performance material FRP (fibre-reinforced plastic) is dimensionally stable, odour-tight, resistant to ageing and absolutely rust-free. The semitransparent tank walls permit an immediate check of the remaining contents.

During fire tests, the Haase basement tank was still absolutely liquid-tight after 30 minutes at temperatures of over 800°C, and has thus demonstrated class "F 30" fire resistance.

The Haase basement tank possesses a walk-on manhole entry, ensuring optimum conditions for later tank maintenance. There is no need to dismantle fittings or connections.

### 70 different standard types

Ten different diameters and 7 heights add up to 70 standard types. Through modification of the jacket height, it is even possible to realise intermediate sizes. And it goes without saying, that the Haase basement tank can also be planned as a multiple-tank installation.

### Always in your neighbourhood!

Over 60 specially trained regional representatives would be pleased to advise you throughout Germany and Europe.

Advice, sales, assembly and service from a single partner!

Tank type	Filling volume (approx. litres)	Jacket height (m)	Tank type	Filling volume (approx. litres)	Jacket height (m)
<b>Reihe K 10: Diameter 1.00 m</b>			<b>Reihe K 22: Diameter 2.20 m</b>		
K 10-08 D	750	1.05	K 22-37 D	3,700	1.05
K 10-10 D	900	1.25	K 22-43 D	4,300	1.25
K 10-11 D	1,100	1.50	K 22-52 D	5,200	1.50
K 10-13 D	1,200	1.70	K 22-59 D	5,900	1.70
K 10-14 D	1,300	1.85	K 22-64 D	6,400	1.85
K 10-16 D	1,600	2.20	K 22-77 D	7,700	2.20
K 10-19 D	1,800	2.50	K 22-87 D	8,700	2.50
<b>Reihe K 13: Diameter 1.30 m</b>			<b>Reihe K 25: Diameter 2.50 m</b>		
K 13-14 D	1,200	1.05	K 25-50 D	4,700	1.05
K 13-16 D	1,500	1.25	K 25-58 D	5,700	1.25
K 13-20 D	1,800	1.50	K 25-70 D	6,800	1.50
K 13-22 D	2,000	1.70	K 25-79 D	7,700	1.70
K 13-24 D	2,200	1.85	K 25-86 D	8,300	1.85
K 13-28 D	2,600	2.20	K 25-100 D	10,000	2.20
K 13-32 D	3,000	2.50	K 25-115 D	11,400	2.50
<b>Reihe K 15: Diameter 1.50 m</b>			<b>Reihe K 30*: Diameter 3.00 m.</b>		
K 15-18 D	1,700	1.05	K 30-69 D	6,900	1.05
K 15-21 D	2,000	1.25	K 30-82 D	8,200	1.25
K 15-25 D	2,400	1.50	K 30-98 D	9,800	1.50
K 15-28 D	2,700	1.70	K 30-112 D	11,200	1.70
K 15-31 D	3,000	1.85	K 30-122 D	12,200	1.85
K 15-36 D	3,600	2.20	K 30-144 D	14,400	2.20
K 15-42 D	4,000	2.50	K 30-165 D	16,500	2.50
<b>Reihe K 17: Diameter 1.70 m</b>			<b>Reihe K 35*: Diameter 3.50 m</b>		
K 17-22 D	2,000	1.05	K 35-94 D	9,400	1.05
K 17-27 D	2,500	1.25	K 35-112 D	11,200	1.25
K 17-33 D	3,000	1.50	K 35-135 D	13,500	1.50
K 17-37 D	3,400	1.70	K 35-153 D	15,300	1.70
K 17-40 D	3,700	1.85	K 35-166 D	16,600	1.85
K 17-48 D	4,400	2.20	K 35-197 D	19,700	2.20
K 17-55 D	5,000	2.50	K 35-224 D	22,400	2.50
<b>Reihe K 19: Diameter 1.90 m</b>			<b>Reihe K 40*: Diameter 4.00 m</b>		
K 19-30 D	2,800	1.05	K 40-123 D	12,300	1.05
K 19-34 D	3,300	1.25	K 40-147 D	14,700	1.25
K 19-40 D	4,000	1.50	K 40-176 D	17,600	1.50
K 19-45 D	4,500	1.70	K 40-200 D	20,000	1.70
K 19-50 D	4,900	1.85	K 40-217 D	21,700	1.85
K 19-58 D	5,800	2,20	K 40-258 D	25,800	2,20
K 19-67 D	6,600	2,50	K 40-293 D	29,300	2,50

\* Tanks of the series K 30, K 35 and K 40 are not covered by the national technical approval certificates nos. Z 40.11-126 and -127 from DIBt

**HAASE**  
**HAASE TANK GMBH**

Your contact: