

Schematic construction of a Haase hot water buffer tank

Lid

Lid insulation
(200 mm mineral insulation)

Pressure relief

Container lid

Level indicator

**Airbleed/
safety overflow**

Flange connections
for access to pressu-
reless water

**Temperature
sensor tubes**

**Airbleed/
safety overflow**

Tank insulation
(Depending on dia-
meter, min. 100 mm
mineral insulation)

External tank wall

Flange connections
for access to pressu-
reless water

Floor insulation
100 mm Styrodur

Tank floor

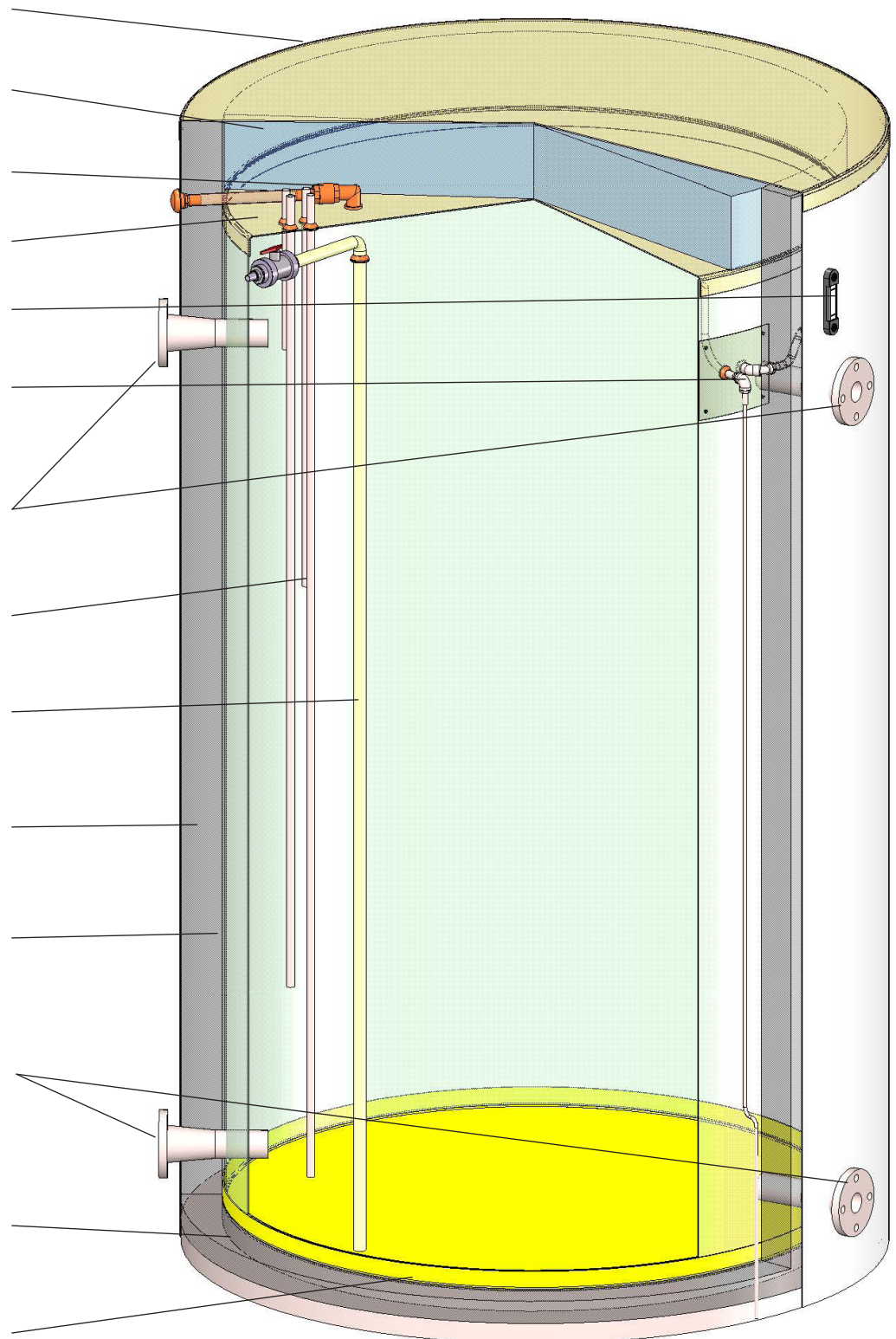



Example of external heat exchanger

Areas of application:

- Ideal for short time storage of energy

Advantages:

- Short time deposits of large volumes of energy
- External heat exchangers avoid calcification issues
- Suitable for large temperature differences in flow and return lines
- Quick accumulation and response on usable high temperatures

Particulars:

- This system requires an external heat exchanger and a pump. We also recommend a balancing valve to control and maximise circulation
- This piping network must be below the water level in the tank at all times

Available flanges*:

DN 32
DN 50
DN 65
DN 80
DN 100

* additional sizes upon request

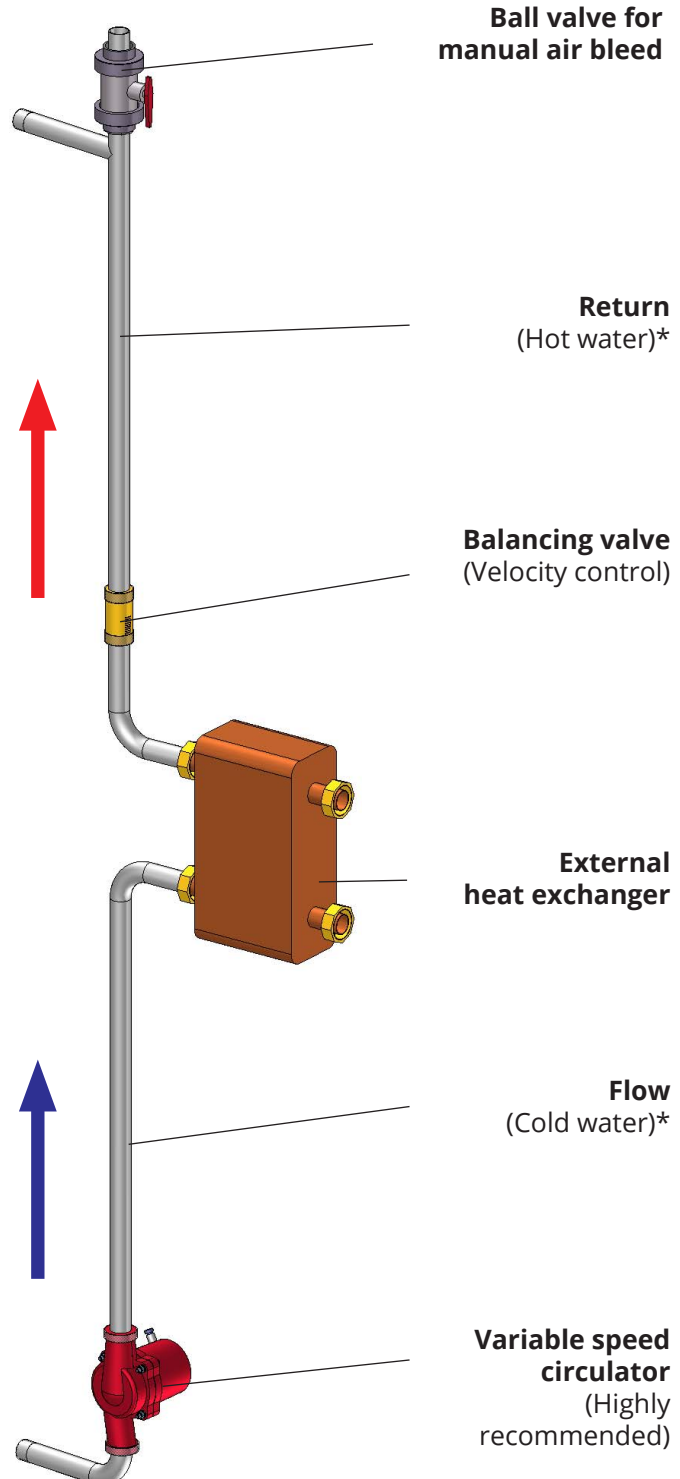

(This sketch is for demonstration only and needs to be adapted to suit individual projects.)

* sample use for loading