

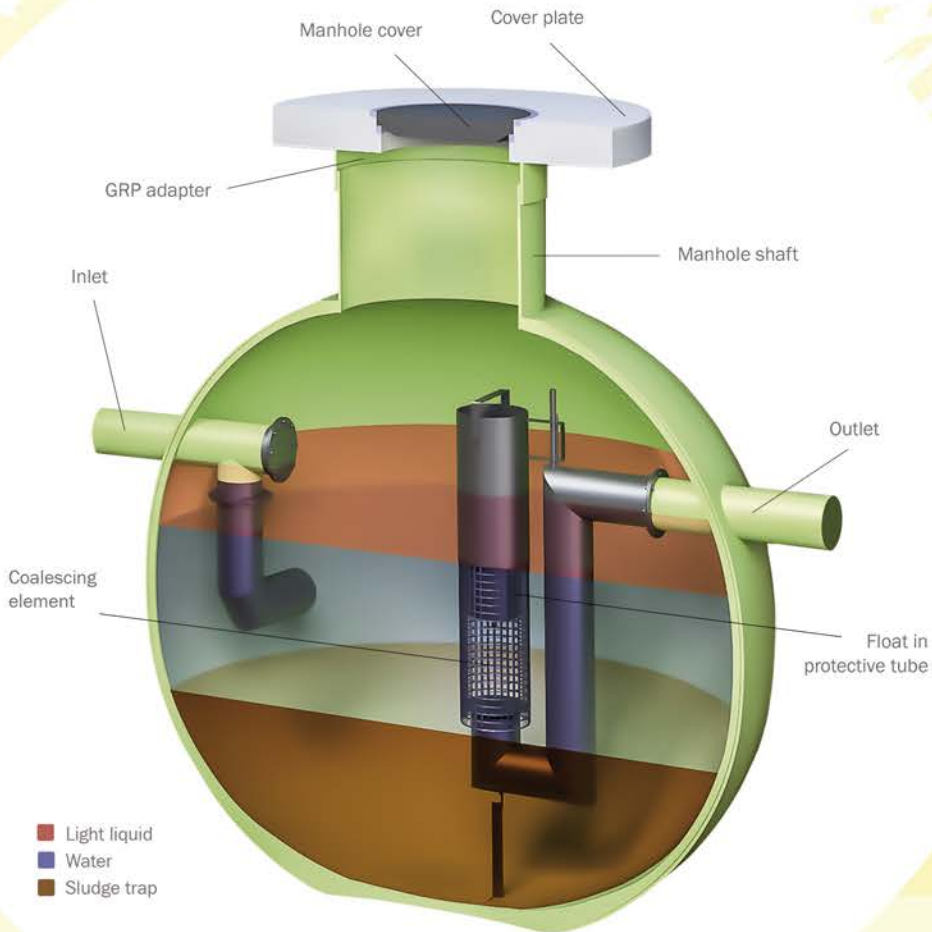

LIGHT LIQUID SEPARATOR LPA WITH OUTLET PLUG

5 1/4
years warranty
for tightness

Coalescing separator (Class I) to DIN EN 858 and DIN 1999 - 100/101
with general building authority approval applied for and 5 1/4 year guarantee on leak-tightness and function



The LPA is a coalescing separator (Class I) with sludge trap and self-actuating stop at the outlet, optionally with or without integrated sampling point.

Consistent clarification and low-maintenance operation are guaranteed by the filterless coalescing insert.



Both the float and the coalescing basket can be removed and replaced from above while the plant is full, without first disposing of the contents.

For general inspection, the plug bladder can be positioned without removing the inlet and outlet components.

THE ADVANTAGES

- FILTERLESS UP TO NOMINAL SIZE 15
- PROBLEM-FREE ACCESS
- SIMPLE LEAK TESTING
- LOW INLET DEPTHS
- SIMPLE, ROBUST ENGINEERING



TECHNICAL DATA



The specified dimensions relate to the minimum inlet depth with trafficable manhole cover D 400.

Smaller dimensional adaptations can be effected by means of the sliding adapter piece (10 mm to 100 mm) and for greater installation depths the GRP shaft can be seamlessly lengthened.

The dimensions AT₀ and AT_u refer to the variants without sampling point; with integrated sampling point the drop from inlet to outlet is 40 mm.

Including mounting fixture and protective tube connection in the shaft with rubber compression seal for warning device cable extension.

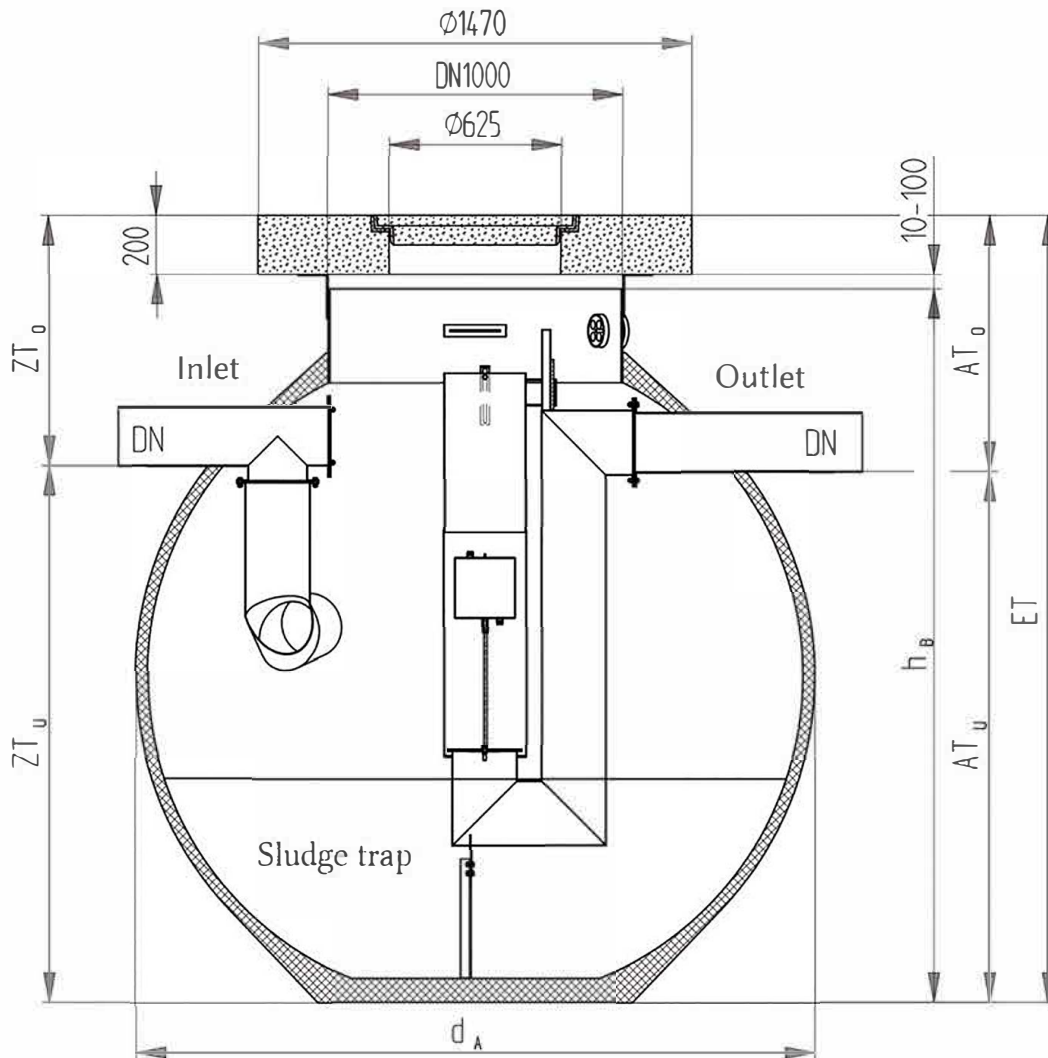

Type	Nominal size	Nominal sludge trap volume	Oil storage volume	Connection size	Outside diameter	Tank height	Installed depth	Inlet depth		Outlet depth		Weight
								ZT ₀ [mm]	ZT _u [mm]	AT ₀ [mm]	AT _u [mm]	
LPA 06-1200	6	1.200	700	150	2.100	1.640	1.890	850	1.040	870	1.020	1.300
LPA 06-6460	6	6.460	700	150	2.300	2.420	2.670	850	1.820	870	1.800	1.900
LPA 10-2500	10	2.500	700	150	2.200	1.900	2.150	850	1.300	870	1.280	1.500
LPA 10-6460	10	6.460	700	150	2.300	2.420	2.670	850	1.820	870	1.800	1.900
LPA 15-3000	15	3.000	1.010	200	2.300	2.420	2.670	850	1.820	870	1.800	1.900
LPA 15-8960	15	8.960	1.470	200	2.800	2.810	3.060	850	2.210	870	2.190	2.500
LPA 20-5000	20	5.000	1.420	200	2.700	2.470	2.720	850	1.870	870	1.850	2.200
LPA 20-8960	20	8.960	1.470	200	2.800	2.810	3.060	850	2.210	870	2.190	2.500